

REFRIGERATED MIG-MAG TORCH WCM 501

DIAGRAM WCM 501

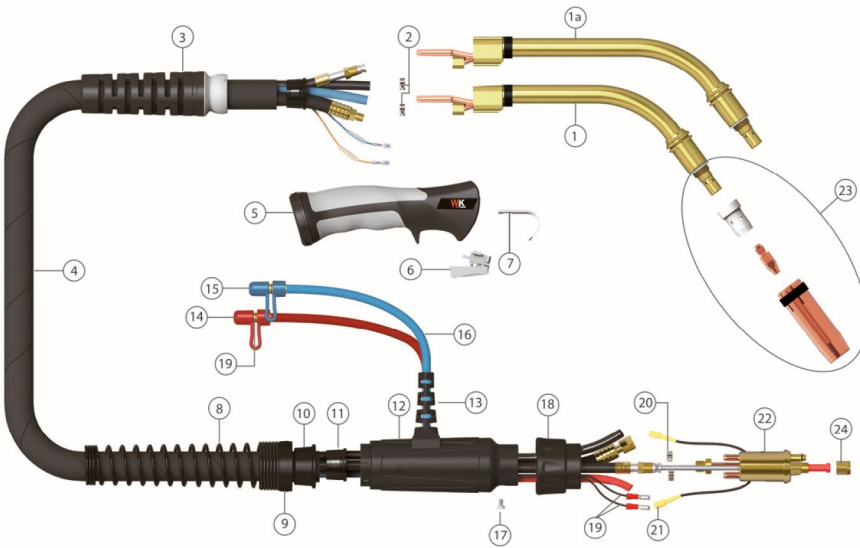

WCM 501

Welding torches Cooled Mig torch

The WCM 501 is a water-cooled torch with 30% reduced weight compared to other similar torches on the market.

Greatly functional and with an ergonomic design, it is the perfect aid for highly demanding jobs.

Exploded

- | | | | |
|-----|------------------------|----|--------------------------|
| 1 | Gooseneck | 13 | Hose attachment |
| 1st | long gooseneck | 14 | Red cap |
| 2 | 8.7mm water hose clamp | 15 | Blue cap |
| 3 | Front bracket | 16 | Cooling water hose |
| 4 | Cable set | 17 | Screw |
| 5 | Handle | 18 | Lock nut |
| 6 | Trigger | 19 | Male cable terminal |
| 7 | Hook | 20 | Water hose clamp 9.5mm |
| 8 | Rear spring | 21 | Female cable terminal |
| 9 | Spring retaining nut | 22 | Connection cylinder |
| 10 | Clamp | 23 | See spare parts page. 59 |
| 11 | Retainer | 24 | Cable lock nut |
| 12 | Rear body assembly | | |



Main features

- 500A CO2
- 450A Mixed Gas
- EN60974-7
- 100% Duty Cycle
- Threads 1.0mm - 1.6mm

