

MIG-MAG WM 300 TORCH

DIAGRAM WM 300

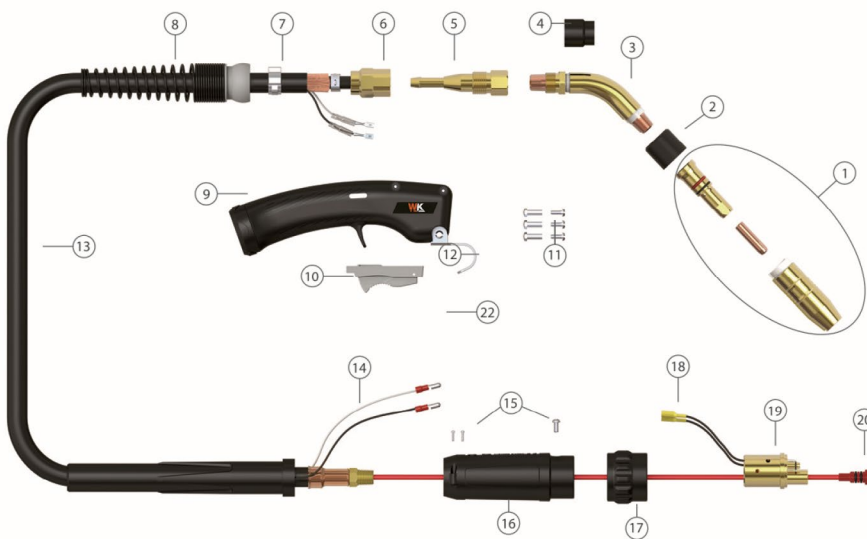

WM 300

Welding Torches Mig Torches

The WM series of air cooled MIG MAG torches provide the welder with great versatility and ergonomics.

They are designed to withstand highly demanding work regimes. They have a point of rotation at the base of the grip for increased durability of the torch.

Exploded

- | | | | |
|----|-----------------------------|----|-----------------------|
| 1 | See spare parts page. 55-58 | 13 | Coaxial cable |
| 2 | Nozzle insulator | 14 | Terminal male cable |
| 3 | Gooseneck | 15 | Screws |
| 4 | Neck insulator | 16 | Rear body |
| 5 | Adapter nut | 17 | Lock nut |
| 6 | Nut | 18 | Terminal female cable |
| 7 | Clamp | 19 | Connection cylinder |
| 8 | Front spring | 20 | Tow rope |
| 9 | Handle | | |
| 10 | Trigger | | |
| 11 | Screws | | |
| 12 | Hook | | |

Main features

- 300A CO2
- 200A Mixed gas
- EN60974-7
- 60% Duty Cycle
- 0.8mm - 1.2mm 500A CO2 wires

