

MIG-MAG WM 400 TORCH

DIAGRAM WM 400

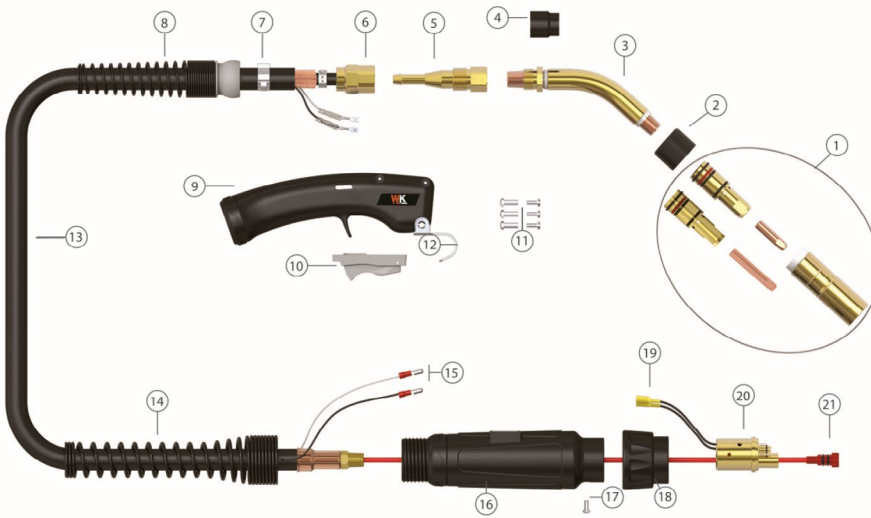

WM 400

Welding Torches Mig Torches

The WM series of MIG MAG air cooled torches provide the welder with great versatility and ergonomics.

They are designed to withstand highly demanding work regimes. They have a point of rotation at the base of the grip for increased durability of the torch.

Exploded

- | | | | |
|----|-----------------------------|----|-----------------------|
| 1 | See spare parts page. 55-58 | 13 | Coaxial cable |
| 2 | Nozzle insulator | 14 | Rear spring |
| 3 | Gooseneck | 15 | Terminal male cable |
| 4 | Neck insulator | 16 | Rear body |
| 5 | Adapter nut | 17 | Screw |
| 6 | Nut | 18 | Lock nut |
| 7 | Clamp | 19 | Terminal female cable |
| 8 | Front spring | 20 | Connecting cylinder |
| 9 | Handle | 21 | Towrope |
| 10 | Trigger | | |
| 11 | Screw | | |
| 12 | Hook | | |



Main features

- 400A CO2
- 320A Mixed gas
- EN60974-7
- 60% Duty Cycle
- Threads from 0.8mm - 1.6mm

