

MIG-MAG WCM 150 TORCH

DIAGRAM WCM 150

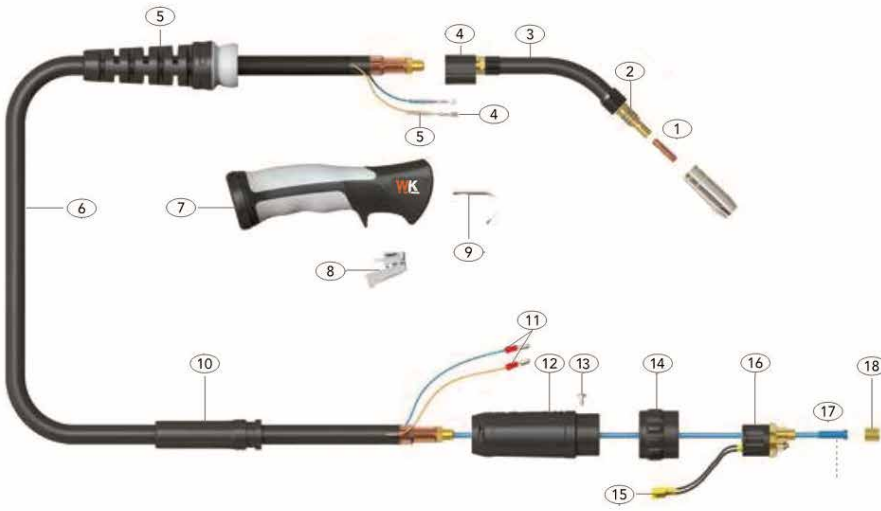

WCM 150

Welding torches Mig Torches

The WCM series of air cooled MIG MAG torches provide the welder with great versatility and ergonomics.

They are designed to stand highly demanding work regimes. They have a rotation point at the base of the grip for increased durability of the torch.

Exploded

- | | | | |
|---|---------------------------------|----|-----------------------|
| 1 | See spare parts on Pages 71-72 | 10 | Rear cable support |
| 2 | Pier | 11 | Male cable terminal |
| 3 | Swan neck | 12 | Rear body |
| 4 | Support sleeve | 13 | Screw |
| 5 | Articulated front cable support | 14 | Lock nut |
| 6 | Coaxial cable | 15 | Terminal female cable |
| 7 | Handle | 16 | Connecting cylinder |
| 8 | Trigger | 17 | Towrope |
| 9 | Hook | 18 | Towrope nut |

Main features

- 150A CO2
- 200A Mixed gas
- EN60974-7
- 60% Duty Cycle
- Threads of 0.8mm - 1.2mm

