

## MIG-MAG WCM 360 TORCH

DIAGRAM WCM 360

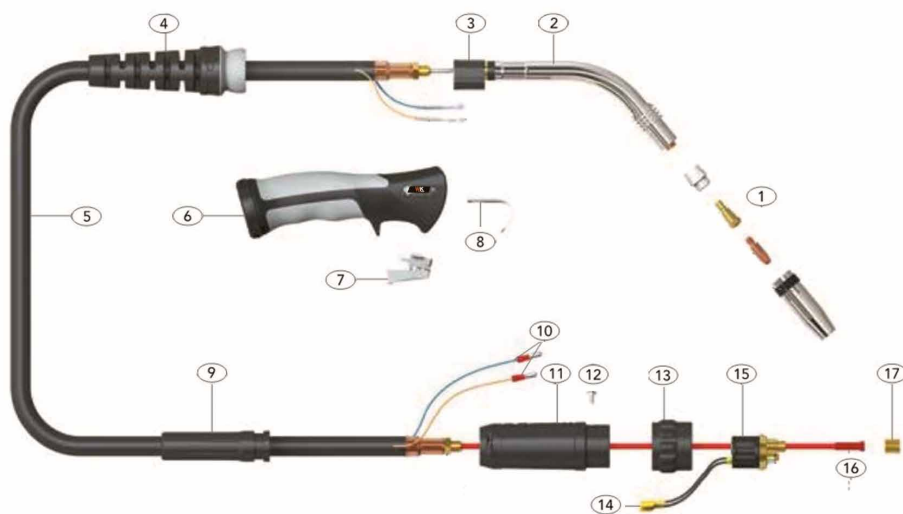

### WCM 360

#### Welding torches Mig Torch

The WCM series of air cooled MIG MAG torches provide the welder with great versatility and ergonomics.

They are designed to stand highly demanding work regimes. They are equipped with a rotation point at the base of the grip for increased durability of the torch.

### Exploded

- |   |                                 |    |                       |
|---|---------------------------------|----|-----------------------|
| 1 | (See spare parts on page 71-72) | 9  | Rear cable support    |
| 2 | Swan neck                       | 10 | Terminal male cable   |
| 3 | Support sleeve                  | 11 | Rear body             |
| 4 | Articulated front support       | 12 | Screw                 |
| 5 | Coaxial cable                   | 13 | Lock nut              |
| 6 | Handle                          | 14 | Terminal female cable |
| 7 | Trigger                         | 15 | Connection cylinder   |
| 8 | Hook                            | 13 | Lock nut              |
|   |                                 | 14 | Terminal female cable |
|   |                                 | 15 | Connection cylinder   |
|   |                                 | 16 | Towrope               |
|   |                                 | 17 | Towrope nut           |

### Main features

- 360A CO<sub>2</sub>
- 200A Mixed gas
- EN60974-7
- 60% Duty Cycle
- Threads of 0.8mm - 1.2mm

